

ATB HYDRAULIC BREAKER

NUOHE MACHINERY

Shanghai Nuo He Machinery Co., LTD
Factory Add:No. 270, Shuanggao Road, Qiqiao Street, Gaochun District, Nanjing City, Jiangsu Province
Tel: +86 18302959409 /+86 18621893796

The promotional brochure is for publicity and reference purposes only. The final interpretation rights belong to Shanghai Nuohe Machinery Co., Ltd.

ATB HYDRAULIC BREAKER

NUO HE MACHINERY



WELCOME

THE COMPLETE LINE
OF ATB BREAKER OFFER
POWERFUL PERFORMANCE
IN A DESIGN THAT
ENHANCES VERSATILITY
AND CONVENIENCE.

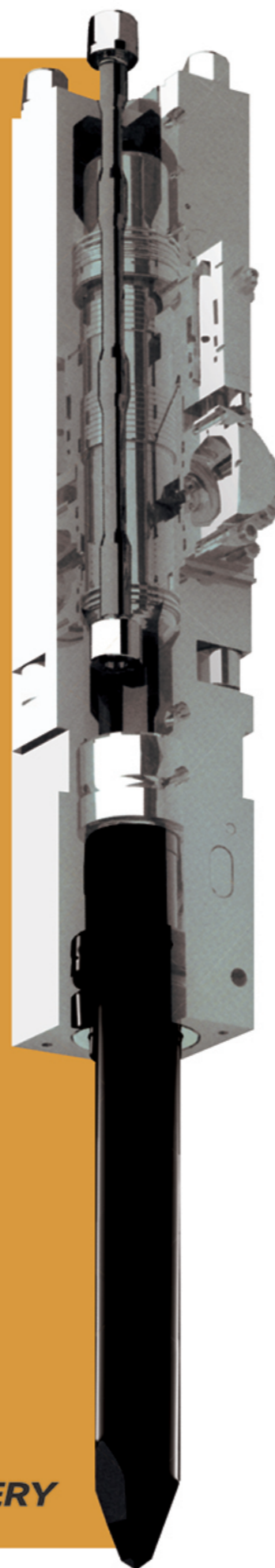

**ATB BREAKER
NUOHE MACHINERY**

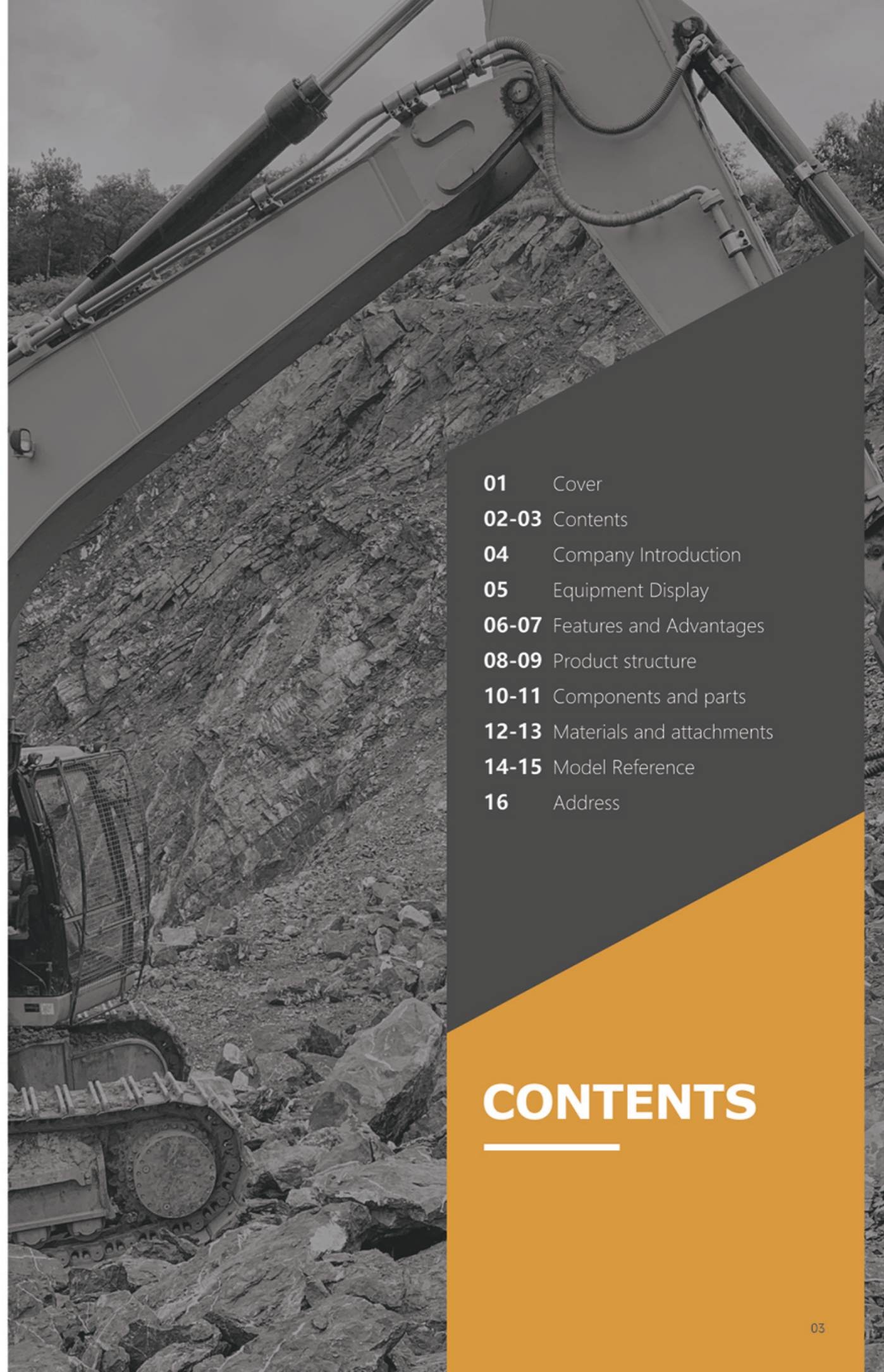

- 01 Cover
- 02-03 Contents
- 04 Company Introduction
- 05 Equipment Display
- 06-07 Features and Advantages
- 08-09 Product structure
- 10-11 Components and parts
- 12-13 Materials and attachments
- 14-15 Model Reference
- 16 Address

CONTENTS

About Us

Founded in 2009, SHANGHAI NUOHE MACHINERY CO., LTD has been engaged in the hydraulic breaker field for more than 15 years. After years of development, the factory has been expanding its scale, with more than 200 employees now. We work together in R&D, production, sales and other positions, laying a solid foundation for the steady progress of the factory. The company's ATB breaker brand is quite influential, offering box-mounted series, top-mounted series, and side-mounted series, with models ranging from ATB-40 to ATB-280, which can meet the needs of excavators of different tonnages. It is widely used in various fields such as mining, demolition, tunnels, and aerial work.

With excellent product quality and continuous technological innovation, the factory has built a sound sales network. Domestically, there are more than 90 signed agents, covering many cities and regions, enabling products to reach customers in various places quickly. In the international market, products are exported to more than 40 countries, especially recognized in regions such as India, the Middle East, Europe, America and Russia. At the same time, more than 20 overseas agents are arranged to provide efficient services for overseas customers. ATB breaker is famous for its advantages such as strong impact force, stable working performance, long service life, and low maintenance cost. It is suitable for working places in various high-temperature and extremely cold weather conditions, and are deeply trusted by users.

The company always puts product quality and compliance first, strictly controlling every link of production. At present, it has obtained international CE certification and ISO9001 certification, which not only affirms the factory's product quality and management system, but also makes the products more competitive in domestic and foreign markets, meeting the standards and requirements of different regions. Whether facing complex mining environments or harsh demolition operations, ATB breakers can perform stably with excellent performance.

Over the past 15 years, relying on extensive market coverage, professional teams, perfect services and authoritative certifications, SHANGHAI NUOHE MACHINERY CO., LTD has established a good reputation in the industry. More than 90 domestic signed agents and more than 20 overseas agents together form a strong sales matrix, providing comprehensive support for customers.

In the future, we will continue to uphold its original aspiration, continuously improve product performance and service level, and rely on the improved domestic and foreign sales networks to provide better ATB breaker products for global customers, achieving win-win development with customers.

Equipment Display

PROCESSING EQUIPMENT



MAZAK 8800 CNC



DOOSAN CNC



PUMA CNC TURNING CENTER

GRINDING EQUIPMENT



High-precision grinding Equipment



Vertical Grinding Equipment

HEAT TREATMENT EQUIPMENT



CUTTING TOOL STOREHOUSE



TESTING EQUIPMENT

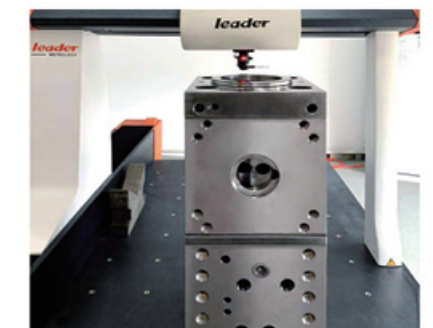

Three-coordinate Measurement





Features and Advantages

Strong "Hydraulic Pressure + Nitrogen Gas" impacting system
 The most important character of breaker is its hitting frequency and impacting capacity. Each model of ATB breakers is provided with strong impacting power system. This system has high efficiency, and its loss of energy can be reduced to the minimum while the impacting capacity is maximized. All ATB series of breakers can give first-class strong impacting and rigging capacity.
 Design of impact reinforced structure
 ATB hydraulic breakers have adopted the most excellent design concept, to increase the stable of piston and cylinder body, so that breakers can have a maximum matching rate with mainframes.
 Flow Adjustable Device
 This device can effectively adjust the flow from garb or power source, thus to adjust the required of rocks large impacting force with slow speed, while small impacting force with fast speed.



1 SILENT TYPE
 BOX-SILENCED TYPE
 ① Reduce noise
 ② Protect the environment

2 TOP TYPE
 TOP TYPE
 ① Easy to locate and control
 ② More conducive to excavate
 ③ Weight lighter, the lower risk of broken drill rod

3 SIDE TYPE
 SIDE TYPE
 ① Overall length shorter
 ② Hook back things conveniently
 ③ Maintenance-free
 ④ Suitable for mine construction

SCHEMATIC DIAGRAM

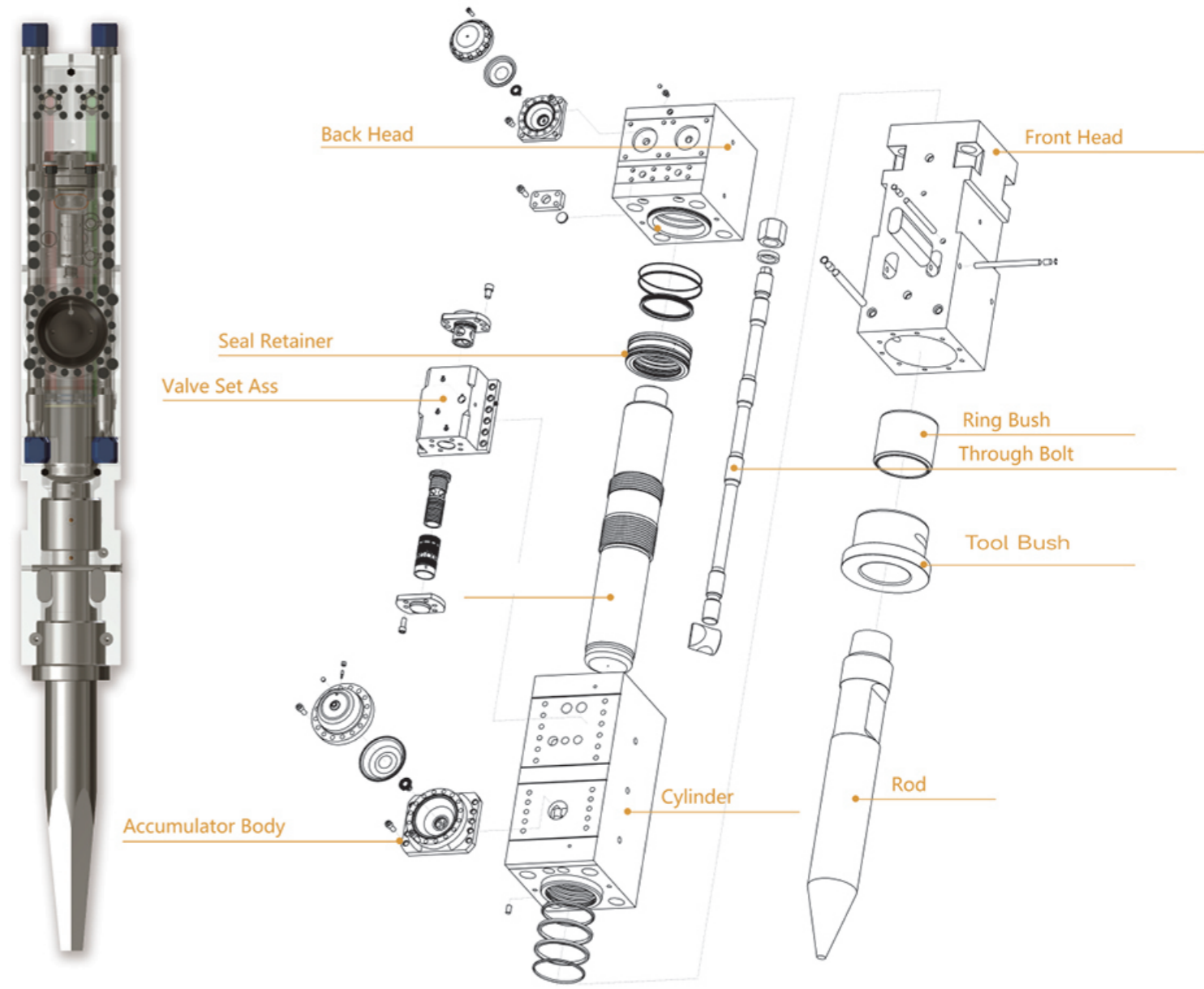

WE GUARANTEE THAT THE GENUINE PARTS' QUALITY & ABILITY

Rod (chisel)

It is the final part that delivers the impact energy from the breaker to the blowing target. There are special types of the rod for various applide operations and tasks.

Front Head

It is the passage part where the kinetic energy of the piston is converted into the impact energy to the rod.

Cylinder

It is intricated connected with both the hydraulic oil passage and the grooves and xes the stroke distance of the piston. Cylinder is considered as the core of the hydraulic breaker in which the Control valve system moves in accordance with the straight reciprocation of the piston.

Piston

It is operated by the straight reciprocation in the cylinder and by means of the hydraulic pressure energy. It combines the accumulated hydraulic pressure energy and the gas energy and carries the kinetic energy which is converted into the impact energy when it hits the rod.

Accumulator

The accumulator compensates the pressure in the hydraulic circuit during the operation to prevent a pulsation effect which might damage the carrier (ATB135-ATB280)

Control Valve

It manages closing & opening of the hydraulic oil circuit in the cylinder and controls the ascending & descending reciprocation movement of the piston with a complex mechanism.

Back Head

It has the gas chamber filled with the N2 gas to accumulate the gas pressure when the piston goes upward.

Through Bolt

It is one of the most important parts of the breaker supports the smooth straight reciprocation movement of the piston.



Small Size Cylinder



Cylinder



Cylinder



Cylinder



Valve Sleeve



Valve Core



Valve Core



Valve



Housing



Housing



Thrust Bush



Tool Bush



Valve Cover



Valve Assembly



Accumulator



Accumulator



Through Bolt



Piston



Rod



Frequency adjustor

HIGH QUALITY SPECIAL STEELS

Based on the exact information of the features of various steel materials, NUOHE provides the optimal products that meet, customer demands and their specifications



AUTOMATED HEAT TREATMENT PROCESS

NUOHE has been leading in the heat treatment technologies, developed various and High-end heat treatment technologies that most appropriated to the circumstances of use of breakers and now applies those technologies to the productions



HIGH QUALITY ATTACHMENT

Please contact NUOHE for more information



Crushing Pliers

End crushing force MAX577KN
MIN429KN
Opening MAX780MM



Stone Grabber



Wood Grab



Crushing Bucket



Clamp Bucket



High-frequency
Crusher



Vibratory Rammer



Bucket



Lift



Hydraulic Shear



Scarifier



Quick Coupler



Pile Driver





ATB PARAMETERS OF HYDRAULIC BREAKER

Parameter	Total weight			Length			Oil flow	Work pressure	Frequency	Hose diameter	Diameter of chisel	length of chisel	Noise 85dB(A) Distance	Suit excavator
	Silent	Top	Side	Silent	Top	Side								
ATB-45	128	108	98	1279	1294	1071	20-40	90-120	700-1200	1/2	45	500	3~6	0.8-1.5
ATB-53	170	169	145	1446	1436	1170	20-50	90-120	600-110	1/2	53	580	4~8	2.5-4.5
ATB-70	343	267	275	1652	1598	1398	40-70	110-140	500-900	1/2	70	700	5~10	4T-7T
ATB-75	477	357	373	1862	1787	1545	50-90	120-150	400-800	1/2	75	750	6~12	6-9T
ATB-85	658	597	536	2140	2109	1778	60-100	130-160	400-800	3/4	85	850	6~12	7-14T
ATB-100	935	889	768	2310	2284	1946	80-110	150-170	350-700	3/4	100	1000	7~14	11-16T
ATB-125	1422	1636	1336	2609	2634	2236	90-120	150-170	350-650	1	125	1100	10~18	15-18
ATB-135	1669	1852	1608	2706	2713	2283	120-180	160-180	350-500	1	135	1200	16~22	18-21

ATB PARAMETERS OF HYDRAULIC BREAKER

Parameter	Total weight			Length			Oil flow	Work pressure	Frequency	Hose diameter	Diameter of chisel	length of chisel	Noise 85dB(A) Distance	Suit excavator
	Silent	Top	Side	Silent	Top	Side								
ATB-140P	1849	2081	1799	2786	2824	2411	120-140	160-180	350-500	1	140	1250	16~22	18-26
ATB-150	2550	2689	2577	3228	3106	2611	150-210	160-180	300-450	1	150	1400	21~30	25-30
ATB-155	2634	2986	2843	3161	3133	2704	180-240	160-180	300-450	1 1/4	155	1400	26~35	28-35
ATB-160	2978	3541	3233	3419	3420	2907	200-260	160-180	250-400	1 1/4	165	1500	35~40	30-45
ATB-175	3593	4228	3953	3668	3632	3048	210-290	160-180	150-300	1 1/4	175	1500	38-45	40-55
ATB-180	3852	4519	4147	3761	3743	3154	270-350	160-180	150-250	1 1/4	180	1600	40~48	45-60
ATB-190	4480	5152	4773	3813	3796	3169	270-350	170-190	150-250	1 1/2	190	1600	45~50	45-75
ATB-205	5000	5670	5270	3910	3896	3269	270-350	170-240	120-200	1 1/2	205	1700	45~50	50±3
ATB-210	6345	7011	6639	4345	4295	3845	350-450	180-210	120-220	1 1/2	210	1900	50~55	65-100